

Windows 10 Mail Setup

Click on your mail app.

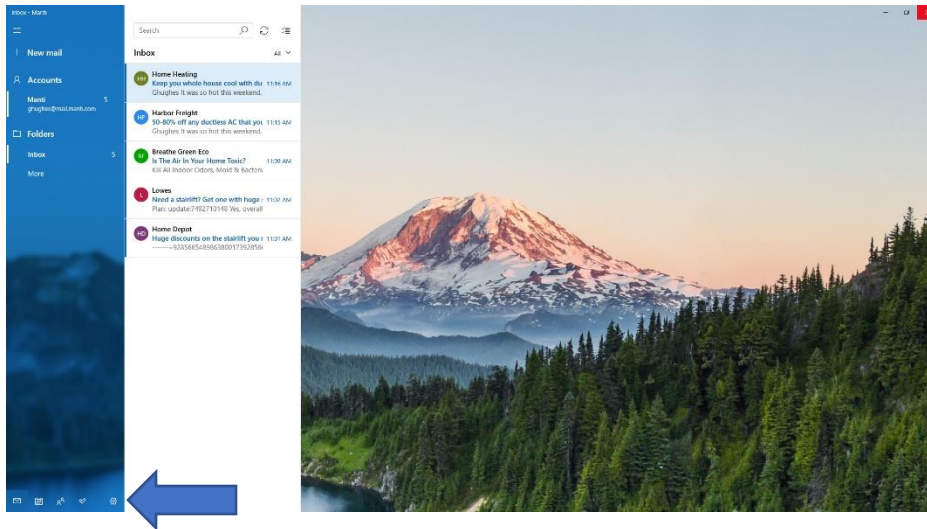

Click on small Gear in lower left corner.



Click on Manage Accounts

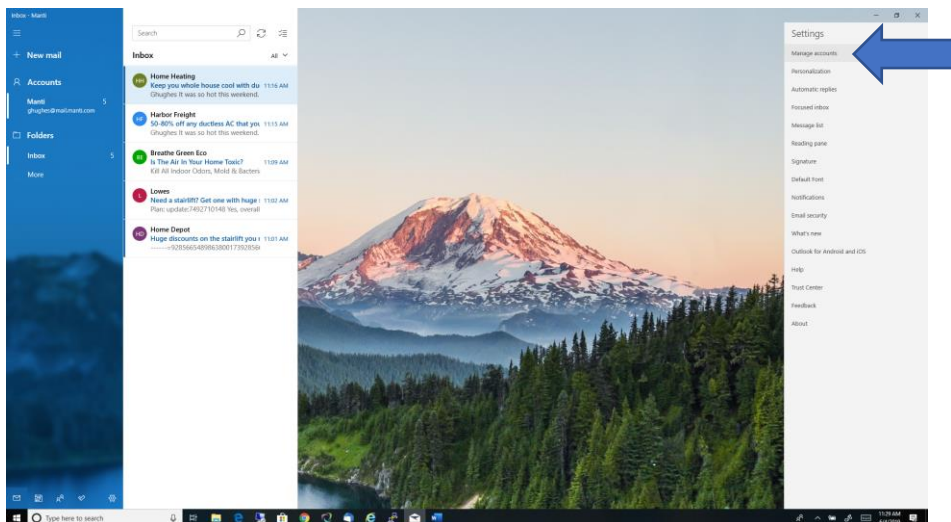

Click on “Add Account”

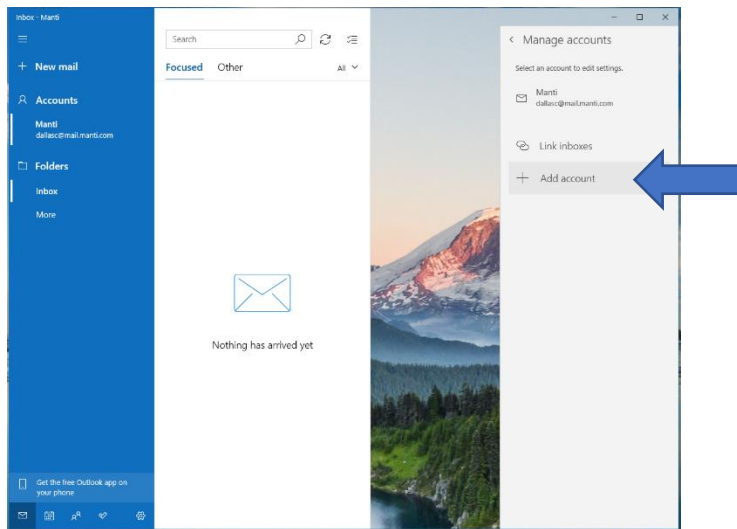

Click on “Advanced setup”

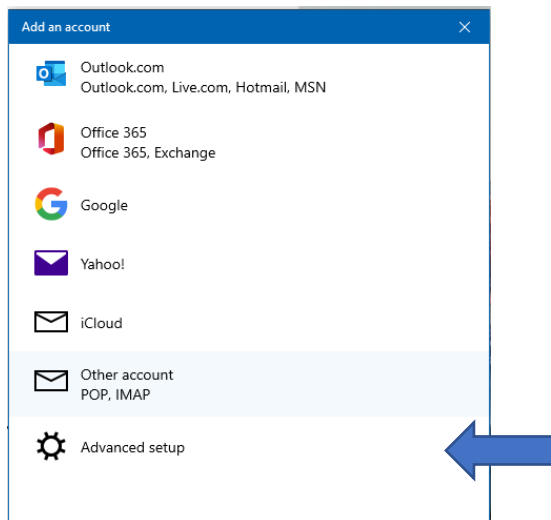

Click on "Internet email"

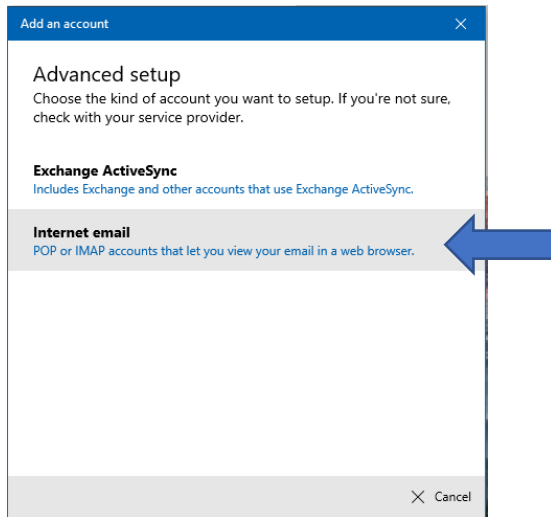

Type in the "Email address," "User name," "Password" and "Account name"

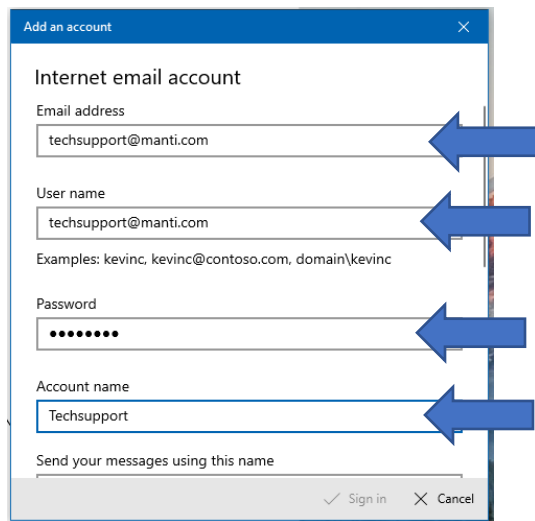

Type in the “Send your messages using this name,” “Incoming email server,” select “IMAP4” from the drop down list under “Account type” and type in the “Outgoing (SMTP) email server”

Add an account

Internet email account

Account name
Techsupport

Send your messages using this name
Techsupport

Incoming email server
imap.bluetie.com

Account type
IMAP4

Outgoing (SMTP) email server
smtp.bluetie.com

✓ Sign in X Cancel

Leave boxes check marked and click “Sign in”

Outgoing server requires authentication

Use the same user name and password for sending email

Require SSL for incoming email

Require SSL for outgoing email

✓ Sign in X Cancel

Click “Done”

Add an account

All done!
Your account was set up successfully.

✉ techsupport@manti.com

Mail gets even better
with Outlook on the
phone

Connect to any email account and
access work and personal calendars
on the go. It's free!

Get the app

✓ Done